

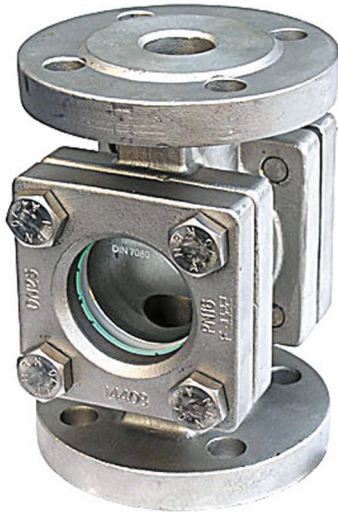

SA-06

Sight Flow Indicator with Flange Connection in Gray Cast Iron, Steel Casting or Stainless Steel



- **Temperature up to 280°C**
- **Nominal diameters DN15 to DN200**
- **PN16, PN25 or PN40**
- **Display with flap, drip tube or rotor**
- **Optionally with ANSI flanges**

Description:

Flow indicators are intended for visualization of flows in pipes. In the case of SA-06, a drip tube or a rotating plastic rotor or a movable flap are viewed through two glasses mounted in a robust flow armature for optical control of flow. Air bubbles and solid particles flowing along or the rotor's rotation speed and the position of the deflected flap enable the observer to quantitatively estimate the volume of flow.

Range of application:

The SA-06 series of flow indicators possesses a flange connection of DIN or ANSI standards. They can be deployed for up to 40 bar of maximum pressure and 280°C maximum temperature. The range of materials available includes gray cast iron, steel casting or stainless steel with NaCa or borosilicate glass. Due to these properties the SA-06 is mainly deployed in the entire manufacturing and processing industry.

Dimensions:

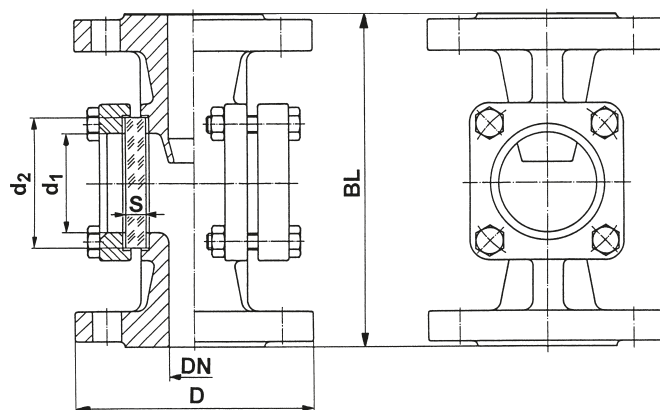

Connection [DIN/ANSI]	D [mm]	BL [mm]	d1 [mm]	d2 [mm]	S [mm] 16 bar	S [mm] 25 bar	S [mm] 40 bar
15 / 1/2"	95	130	32	45	10	10	10
20 / 3/4"	105	150	32	45	10	10	10
25 / 1"	115	160	48	63	10	12	15
32 / 1 1/4"	140	180	48	63	10	12	15
40 / 1 1/2"	150	200	65	80	12	15	20
50 / 2"	165	230	80	100	15	20	25
65 / 2 1/2"	185	290	80	100	15	20	25
80 / 3"	200	310	100	125	20	25	30
100 / 4"	220 (235 for PN25/40)	350	125	150	25	30	35
125 / 5"	250 (270 for PN25/40)	400	150	175	25	30	on request
150 / 6"	285 (300 for PN25/40)	480	175	200	30*	35	on request
200 / 8"	340 (360/375 for PN25/40)	600	175	200	30*	35	on request

* 16 bar only with borosilicate glass available
> DN 100 and PN 40 in accordance with DIN 3237

Ordering codes:

Ordering number: SA-06. 1. 1. 1. 16. 15. 0

Sight Flow Indicator with Flange
Connection in Gray Cast Iron,
Steel Casting or Stainless Steel

Optical display:

- 1 = with drip tube
- 2 = with flap
- 3 = with rotor made of POM
- 4 = with rotor made of PTFE

Housing material:

- 1 = gray cast iron (max. 16 bar)
- 2 = steel casting
- 3 = stainless steel

Glass material:

- 1 = NaCa glass (up to max. 150°C)
- 2 = borosilicate glass (up to max. 280°C)

Connecting flanges:

- 16 = DIN PN16 (standard)
- 25 = DIN PN25 (not for gray cast iron)
- 40 = DIN PN40 (not for gray cast iron)
- 150 = ANSI 150 lbs

Nominal diameter:

- 15 = DN15/1/2"
- 20 = DN20 / 3/4"
- 25 = DN25/ 1"
- 32 = DN32/1 1/4"
- 40 = DN40/1 1/2"
- 50 = DN50/2"
- 65 = DN65/2 1/2"
- 80 = DN80 / 3"
- 100 = DN100 / 4" (not with ANSI flanges in gray cast iron)
- 125 = DN125 / 5" (not with ANSI flanges in gray cast iron)
- 150 = DN150 / 6" (with borosilicate glass only)
- 200 = DN200 / 8" (not with ANSI flanges in gray cast iron, with borosilicate glass only)
- 999 = Nominal diameter > DN200 on request only (special design)

Special design:

- 0 = none
- 1 = please specify in detail

Technical specifications:

Housing materials:	gray cast iron GG 25 or steel casting GS-C 25 or stainless steel 1.4408
Cover:	GG 25 for gray cast iron version GS-C 25 for steel casting version 1.4408 / 1.4301 for stainless steel version
Cover shape:	DN15 to DN50 square DN65 to DN200 round
Screws:	4.6 / 5.6 vz for gray cast iron and steel casting A4-70 for stainless steel version
Optical display:	drip tube for display of least volumes or flap made of stainless steel 1.4571 or rotor made of POM or rotor made of PTFE
Glass material:	NaCa glass DIN 8902 up to max. 150°C or borosilicate glass DIN 7080 up to max. 280°C
Seals:	Graphite (others on request)
Process connections:	DN15 to DN200 flange as per DIN or ANSI
Pressure:	PN16, PN25 or PN40 and 150 lbs./300 lbs. for ANSI standard
Media temperature:	SA-06. (1 or 2) max. 150°C for NaCa glass, 280°C for borosilicate glass SA-06.3 max. 120°C SA-06.4 max. 260°C
Mounting:	horizontally or vertically, for attention to flow direction