



SA-01

Flow Indicator with or without Rotor, with Wiper for Self-Cleaning



Features

/Gases

/Low viscous liquids

/ Small dimensions for assembly

/ Brass and stainless steel versions

/ Any mounting position

/ Optionally, with or without rotor

Visual indicating of flow

/ With internal wiper blades for
internal cleaning of the sight glass

Description:

The SA-01 series of flow indicators is intended for visual indication of flow through a pipe. The medium passing through it can be viewed through a sight glass. Optionally, a rotor placed into the flow is set into motion by the medium which serves as a visual confirmation of the flow. Wiper blades mounted in the device get pressed inside against the sight glass. By simply rotating the sight glass manually, the inside can be cleaned of deposits, formation of algae or calcification without the need to interrupt the process. Thus, elaborate maintenance and cleaning operations can be dispensed with.

Application:

The SA-01 series of flow indicators is deployed for monitoring fluids of low and medium viscosities (up to 150 cSt) in pipes. Optionally the unit can indicate the flow of gases and is equipped with ball bearings in this case.



Technical Specifications:

max. Pressure /	16 bar
Pressure drop at Qmax. /	
SA-01.1:	on request
SA-01.2:	0.25 bar at Qmax
Media temperature /	SA-01.1: 0...+100°C SA-01.2: 0...+100°C
Ambient temperature /	SA-01.1: 0...+100°C SA-01.2: 0...+100°C
Materials /	
Housing:	
SA-01.x.x.1:	brass CW614N nickel plated
SA-01.x.x.2:	st. steel 1.4305
Sight glass:	borosilicate glass
Wiper:	
SA-01.x.x.1:	NBR
SA-01.x.x.2:	FKM
Media:	water, oil, gases
O-ring:	
SA-01.x.x.1:	NBR
SA-01.x.x.2:	FKM
Rotor (SA-01.2.x.x only):	1/4"..1" POM red, 1/4" and 1/2" Nylon white
Mounting position:	any, not in down pipe
Bearing:	sleeve bearing for fluids: peek; sleeve bearing for gases: steel 100 CR 6 chrome coated; ball bearing, greaseless, for gases

Devices for smaller flow volumes and higher operating temperatures on request.

Nominal diameters & flow values:

Con- nection G	L (mm)	with rotor			with rotor (air)		with- out rotor	
		Qmin. (l/min) 1 cST	Qmin. (l/min) 40 cST	Qmin. (l/min) 41-150 cST	Qmin. (l/min abs., 20°C)	Qmax. (l/min 1 bar abs.)		
1/4"	4	0,7	1,5	2,7	4	18	60	15
3/8"	8	0,8	1,5	2,8	8	20	150	20
1/2"	12	1,4	1,8	3,2	12	25	250	30
3/4"	25	1,4	2,7	5,9	25	25	250	60
1"	40	1,7	3	7	40	35	350	90
1 1/4"	80	8	5,9	7,9	80	60	600	150
1 1/2"	100	8	7,3	7,9	100	70	700	220

Dimensions in mm:

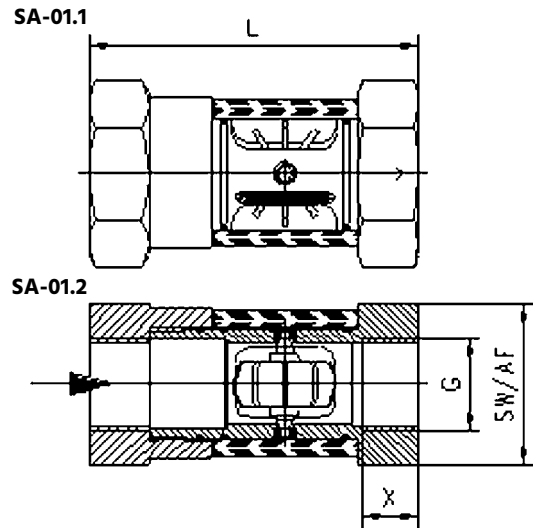

SA-01.1 (without rotor)

SA-01.2 (with rotor)

Con- nection G	L (mm)	X (mm)	SW (mm)	weight (kg)	Con- nection G	L (mm)	X (mm)	SW (mm)	weight (kg)
1/4"	71	9	36	0.3	1/4"	71	9	36	0.35
3/8"	71	9	36	0.3	3/8"	71	9	36	0.35
1/2"	86	13	46	0.6	1/2"	86	13	46	0.65
3/4"	94	16	46	0.6	3/4"	94	16	46	0.65
1"	104	16	46	0.6	1"	104	16	46	0.65
1 1/4"	120	19	65	1.5	1 1/4"	120	19	65	1.6
1 1/2"	130	20	65	1.6	1 1/2"	130	20	65	1.7

Ordering Codes:

Order number SA-01. 2. 3. 1. 2. 1

SA-01 Flow Indicator

Version /

- 1 = without rotor
- 2 = with rotor

Process connection /

- 1 = female thread G 1/4"
- 2 = female thread G 3/8"
- 3 = female thread G 1/2"
- 4 = female thread G 3/4"
- 5 = female thread G 1"
- 6 = female thread G 1 1/4"
- 7 = female thread G 1 1/2"

Material /

- 1 = brass
- 2 = stainless steel

Media /

- 1 = fluids
- 2 = air with ball bearings

Option /

- 0 = none
- 1 = wipers from EPDM